

1.7 EPIC® H - B V E

Einsätze / Inserts / Inserts

Technische Daten:

- Kontaktzahlen: 3, 6, 10 (+ PE)
- Bemessungsspannung/ . . . VDE: 630 V EPIC® H-BVE 3-10
Schraubanschluss: . . . UL: 600 V EPIC® H-BVE 3-10
CSA: 600 V EPIC® H-BVE 3-10
- Käfigzugfederanschluss: . . . VDE: 830 V
- Bemessungsstrom/ VDE: 16 A EPIC® H-BVE 3-10
Schraubanschluss: . . . UL: 16 A EPIC® H-BVE 3-10
CSA: 16 A EPIC® H-BVE 3-10
- Käfigzugfederanschluss: . . . VDE / UL / CSA: 16 A
- Verschmutzungsgrad: 3
- Bemessungsstoßspannung: 6 kV
- Leitungsanschluss: Schraubanschluss: 0,5-2,5 mm²
Käfigzugfederanschluss: 0,14-2,5 mm²
- Temperaturbereich: -40 °C bis +100 °C,
kurzzeitig bis +125 °C
- Kontakte: Kupferlegierung, hartversilbert
- Durchgangswiderstand: . . . <2 mOhm
- Steckzyklen: 100 (je nach Anwendungsfall,
höhere Steckzyklen möglich)

Technical Data:

- Number of contacts: 3, 6, 10 (+ PE)
- Rated voltage/ VDE: 630 V EPIC® H-BVE 3-10
screw termination: . . . UL: 600 V EPIC® H-BVE 3-10
CSA: 600 V EPIC® H-BVE 3-10
- Cage clamp termination: VDE: 830 V
- Rated current/ VDE: 16 A EPIC® H-BVE 3-10
screw termination: . . . UL: 16 A EPIC® H-BVE 3-10
CSA: 16 A EPIC® H-BVE 3-10
- Cage clamp termination: VDE / UL / CSA: 16 A
- Pollution degree: 3
- Dimensioning transient: 6 kV
- Termination technique: Screw termination: 0,5-2,5 mm²
Cage clamp termination: 0,14-2,5 mm²
- Temperature range: -40 °C – +100 °C,
for a short term up to +125 °C
- Contacts: Copper alloy, silver plated
- Contact resistance: <2 mOhm
- Mating cycles: 100 (higher mating cycles
depends on the application)

Caractéristiques techniques:

- Nombre de contacts: 3, 6, 10 (+ PE)
- Tension nominale/ VDE: 630 V EPIC® H-BVE 3-10
raccord à visser: . . . UL: 600 V EPIC® H-BVE 3-10
CSA: 600 V EPIC® H-BVE 3-10
- Lâme de pression: VDE: 830 V
- Courant nominale/ VDE: 16 A EPIC® H-BVE 3-10
raccord à visser: . . . UL: 16 A EPIC® H-BVE 3-10
CSA: 16 A EPIC® H-BVE 3-10
- Lâme de pression: VDE / UL / CSA: 16 A
- Degré de pollution: 3
- Dimensionnement de choc: 6 kV
- Raccordement: Raccord à visser: 0,5-2,5 mm²
Lâme de pression: 0,14-2,5 mm²
- Gamme de température: . . . -40 °C – +100 °C,
à court terme jusqu'à +125 °C
- Contacts: Alliage cuivre, argenté
- Résistance de passage: . . . <2 mOhm
- Cycles d'insertion: 100 (selon le cas cycles
d'insertion plus important)

Nur mit EPIC®-Gehäusen verwenden.
Use only with EPIC® housings.
Utilisez seulement avec boîtiers EPIC®.

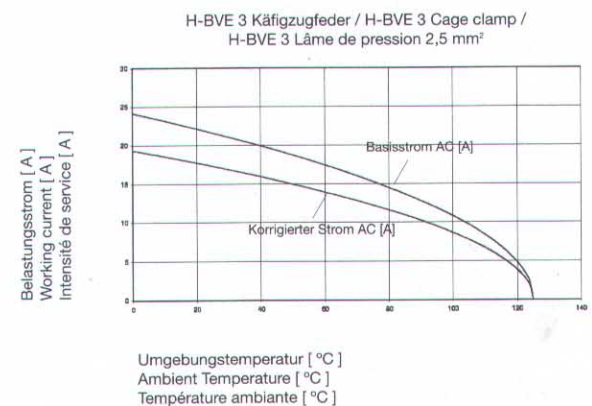
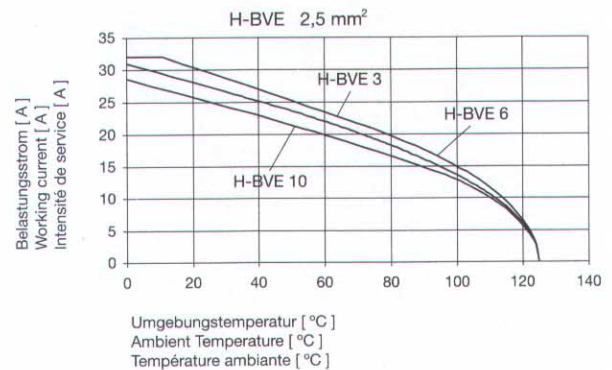
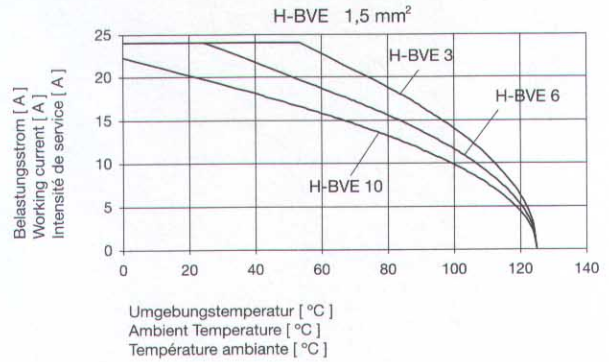

1.7 EPIC® H - B V E

Einsätze / Inserts / Inserts

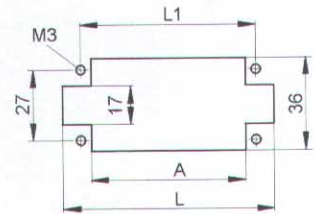
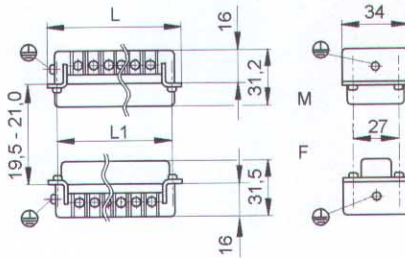
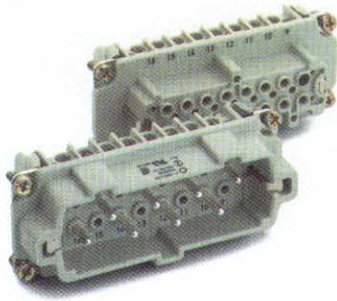

Montageausschnitt
Panel cut-out
Découpe de montage

Schraubanschluss / Screw termination / Raccord à visser

H-BVE 3

Artikel part article	Version version version	Art.Nr. part No. N° art.	Drahtschutz wire protection protection de fil	Kontakte contacts contacts	L	L1	A
H-BVE 3 SS	Stift / male / mâle	10210010	●	3 + 2	64	57	52
H-BVE 3 BS	Buchse / female / femelle	10211010	●	3 + 2	64	57	52
H-BVE 3 SS	Stift / male / mâle	10210110		3 + 2	64	57	52
H-BVE 3 BS	Buchse / female / femelle	10211110		3 + 2	64	57	52

Gehäuse / Housings / Boîtiers:
3.2: H-B 10

Ansicht anschlussseitig
View from cable side
Vue côté raccordement

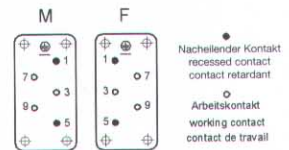

H-BVE 6

Artikel part article	Version version version	Art.Nr. part No. N° art.	Drahtschutz wire protection protection de fil	Kontakte contacts contacts	L	L1	A
H-BVE 6 SS	Stift / male / mâle	10239010	●	6 + 2	84,5	77,5	71
H-BVE 6 BS	Buchse / female / femelle	10240010	●	6 + 2	84,5	77,5	71
H-BVE 6 SS	Stift / male / mâle	10239110		6 + 2	84,5	77,5	71
H-BVE 6 BS	Buchse / female / femelle	10240110		6 + 2	84,5	77,5	71

Gehäuse / Housings / Boîtiers:
3.2: H-B 16

Ansicht anschlussseitig
View from cable side
Vue côté raccordement

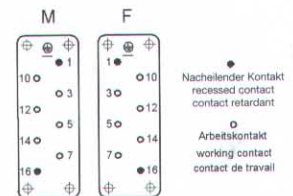

1.7 EPIC® H - B V E

Einsätze / Inserts / Inserts

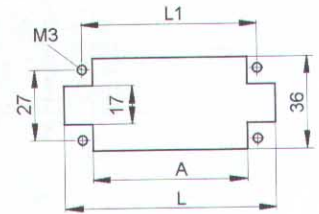
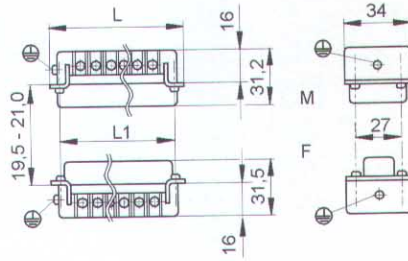
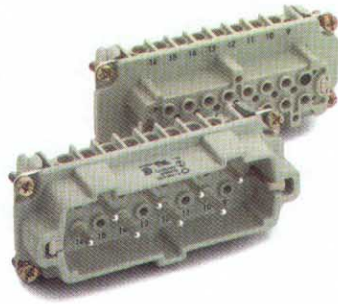

Montageausschnitt
Panel cut-out
Découpe de montage

Schraubanschluss / Screw termination / Raccord à visser

H-BVE 10

Artikel part article	Version version version	Art.Nr. part No. N° art.	Drahtschutz wire protection protection de fil	Kontakte contacts contacts	L	L1	A
H-BVE 10 SS	Stift / male / mâle	10270010	●	10 + 2	111	104	98
H-BVE 10 BS	Buchse / female / femelle	10271010	●	10 + 2	111	104	98
H-BVE 10 SS	Stift / male / mâle	10270110		10 + 2	111	104	98
H-BVE 10 BS	Buchse / female / femelle	10271110		10 + 2	111	104	98

Gehäuse / Housings / Boîtiers:
3.2: H-B 24

Ansicht anschlussseitig
View from cable side
Vue côté raccordement

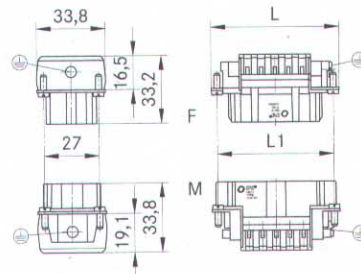
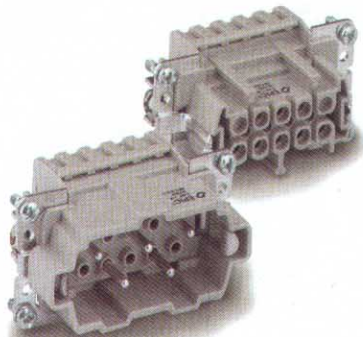
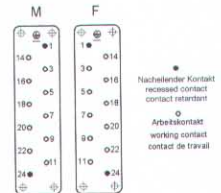

Käfigzugfederanschluss / Cage clamp / Lame de pression

H-BVE 3

Artikel part article	Version version version	Art.Nr. part No. N° art.	Kontakte contacts contacts	L	L1
H-BVE 3 SF	Stift / male / mâle	10210040	3 + 2	62,8	57
H-BVE 3 BF	Buchse / female / femelle	10211040	3 + 2	62,5	57

Gehäuse / Housings / Boîtiers:
3.2: H-B 10

Ansicht anschlussseitig
View from cable side
Vue côté raccordement

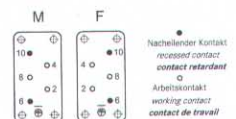

Achtung / Attention / Considération

Nicht steckbar mit H-BVE Einsätze mit Schraubanschluss.

Not mateable with insert H-BVE screw termination.

Ne se peuvent pas intermarier avec des inserts H-BVE avec termination à vis.